

# 經濟部標準檢驗局 應施檢驗商品品目查詢線上回復單

機關地址：臺北市濟南路一段四號

聯絡人：黃映慈

連絡電話：02-2343-1700#1243

電子郵件：yingtzu.huang@bsmi.gov.tw

傳 真：02-3343-3991

申請者：Concept2, Inc.

回復日期：114年06月04日

申請案號：20250602000090

主旨：有關貴公司函詢「ErgLink」商品是否屬本局應施檢驗品目範圍案，復如說明，請查照。

說明：

- 一、復貴公司114年6月2日應施檢驗商品品目查詢單。
- 二、經檢視所附資料(如附件)，旨揭商品係具收集、處理運動鍛鍊數據的裝置，研判非屬本局應施檢驗品目範圍。
- 三、另旨揭商品具無線傳輸功能，是否屬電信管理法管制範疇，請逕洽國家通訊傳播委員會。
- 四、本案應施檢驗品目鑑定結果倘經公告增刪檢驗品目或解釋範圍致有不同時，應以公告或解釋內容為準。另本案係依所附資料判定，若實體商品樣態、使用方法、標示資訊及注意事項等與所附資料不一致時，應依實體商品另為判定。
- 五、有關自國外進口或國內產製之商品，是否歸屬應施檢驗品目，請逕上本局網站（商品檢驗業務申辦服務網<https://civil.bsmi.gov.tw/>商品品目查詢）查詢。
- 六、為促進商品正確標示，於市場流通之商品應依商品標示法相關規定標示；另為保障消費者權益，於市面上銷售之商品應依據消費者保護法第4條及第7條規定，詳實標示使用方法、注意及警告事項。商品之安全性，請參照相關國家標準規定，以確保消費者使用安全（國家標準檢索網站：<https://www.cnsonline.com.tw>）。

# 應施檢驗商品品目查詢單

本公司 ☒ 進口 商品： ErgLink 型號： ErgLink  
☐ 產製

檢附 ☒ 產品中文或英文型錄 1 份  
☐ 樣品 件

查詢是否屬於應施檢驗品目或範圍，請惠復。

此致

經濟部標準檢驗局

申請者： Concept2, Inc.

地址： 105 INDUSTRIAL PARK DR, MORRISVILLE, VT 05661,

聯絡人： Emily Lu

電話： 0912192516

備註：為利民眾查詢本局將公開前商品名稱及檢驗核判內容  
(不包含貴公司檢附之產品型錄資料) 如有任何意見請詳述：

---

中華民國 114 年 06 月 02 日

黃映慈

寄件者: Emily Lu <emi@approve-it.net>  
寄件日期: 2025年6月3日星期二 上午 11:42  
收件者: 黃映慈  
主旨: RE: 關於貴公司品目查詢-申請案號20250602000090 ErgLink · 尚須補充產品資訊  
附件: New Erglink Pictures.pdf; StrengthErg\_Manual\_0525\_chineseErgLink.pdf

您好,

ErgLink 是一款安裝在運動器材上的電子設備, 將性能監測器和產生器的功能整合到一個裝置中。Erglink 用做收集並處理運動鍛鍊的數據, 並透過低功耗藍牙連接將數據傳輸到遠端顯示器和其他設備, 例如智慧型手機或平板電腦。

請參照附件檔的產品照片, 以下為安裝的範例 (可以搭配不同的運動器材做使用)



附件檔使用手冊(搭配運動器材的範例)也請您參考

謝謝

Best Regards  
Emily

---

**From:** 黃映慈 <yingtzu.huang@bsmi.gov.tw>  
**Sent:** Tuesday, June 3, 2025 11:26 AM  
**To:** Emily Lu <emi@approve-it.net>  
**Subject:** 關於貴公司品目查詢-申請案號 20250602000090 ErgLink, 尚須補充產品資訊

呂小姐您好,  
有關貴公司這邊提出品目查詢 ErgLink (申請案號 20250602000090), 尚須補充相關產品資訊。  
請問此產品是放置於運動器材的計數器嗎?可將運動量數據透過藍芽方式傳送到手機?再請補充回復相關產品資訊, 謝謝。

經濟部標準檢驗局  
檢驗行政組資電商品科

黃映慈

電話:02-2343-1700 #1243

電子郵件: [yingtzu.huang@bsmi.gov.tw](mailto:yingtzu.huang@bsmi.gov.tw)

經濟部標準檢驗局電子郵件聲明:

本電子郵件(含附件)僅供收件者依指定目的使用,未依目的使用本郵件內容,或不當之轉寄行為可能違法。

若您並非被指定之收信人或任何原因未經授權下收到本信件,請勿揭曉本郵件內容於任何人,立即以電子郵件通知郵件寄件人,並由您的電腦刪除此信件和銷毀任何已列印的文件。感謝您的合作。

Email Notice of Bureau of Standards, Metrology & Inspection, M.O.E.A,  
ROC

Information in this email and any attachments is intended solely for the use of the individual(s) to whom it is addressed or otherwise directed.

Any unauthorized usage or disclosure of the information may offense the laws.

If you were not the intended recipient or got it unauthorized.

please do not disclose the contents to anyone, and notify the sender by e-mail, delete this message and destroy all printed hard copies.

Thank you for your cooperation.

經濟部標準檢驗局電子郵件聲明:

本電子郵件(含附件)僅供收件者依指定目的使用,未依目的使用本郵件內容,或不當之轉寄行為可能違法。

若您並非被指定之收信人或任何原因未經授權下收到本信件,請勿揭曉本郵件內容於任何人,立即以電子郵件通知郵件寄件人,並由您的電腦刪除此信件和銷毀任何已列印的文件。感謝您的合作。

Email Notice of Bureau of Standards, Metrology & Inspection, M.O.E.A,  
ROC

Information in this email and any attachments is intended solely for the use of the individual(s) to whom it is addressed or otherwise directed.

Any unauthorized usage or disclosure of the information may offense the laws.

If you were not the intended recipient or got it unauthorized.

please do not disclose the contents to anyone, and notify the sender by e-mail, delete this message and destroy all printed hard copies.

Thank you for your cooperation.



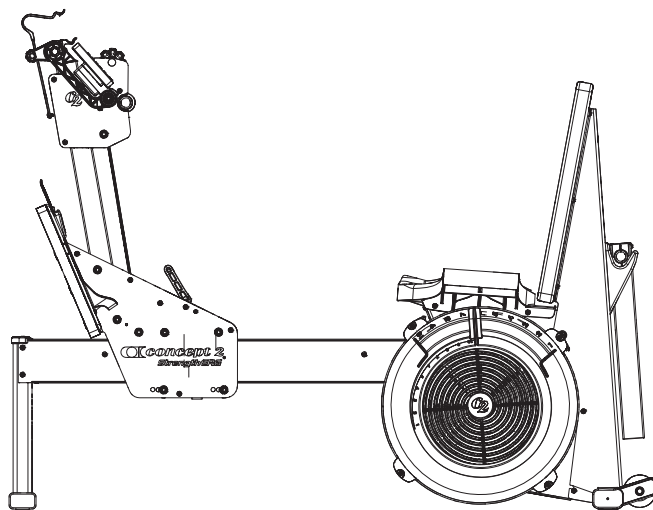

# **concept 2**<sup>®</sup> **StrengthERG**<sup>™</sup>

PRODUCT MANUAL



For complete product information,  
scan the QR code or go to:

[concept2.com/strengtherg-start](http://concept2.com/strengtherg-start)



Download our **FREE**  
**ErgData** app for:

- Workouts
- Logging results
- Data analysis

[concept2.com/ergdata](http://concept2.com/ergdata)



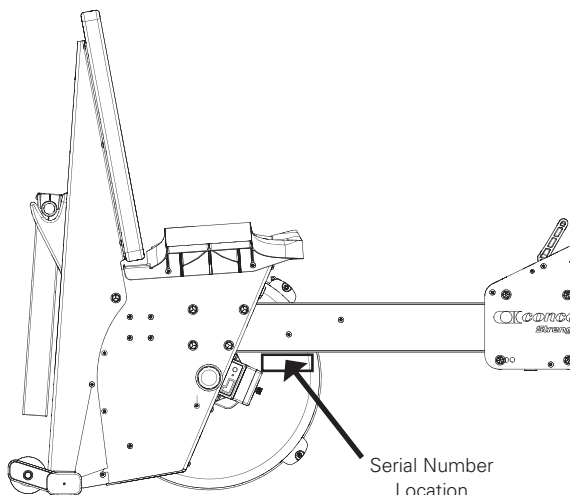

**IMPORTANT NOTE:**

For additional information about Concept2, complete warranty details, or to register to receive product updates:

**concept2.com/registration**

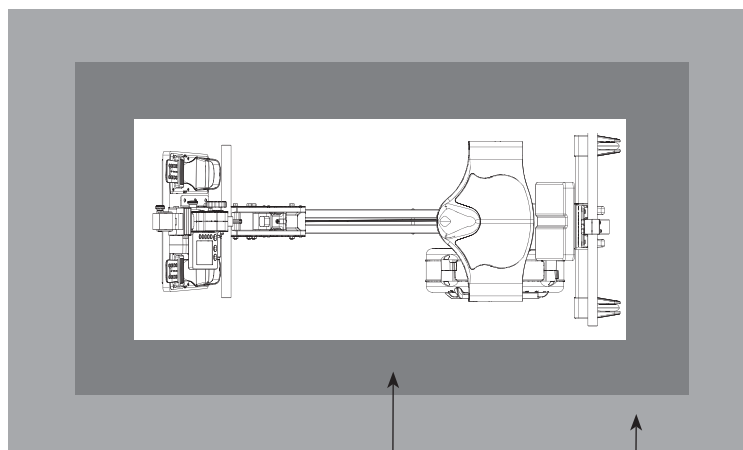

**WEIGHT CAPACITY**

350 lb  
159 kg

**TRAINING AREA**

38 in x 80 in  
97 cm x 203 cm

**FREE AREA**

50 in x 92 in  
127 cm x 234 cm

**MACHINE DIMENSIONS**

26 in x 61 in x 48 in  
66 cm x 154 cm x 122 cm  
Maximum physical dimensions:  
26 in x 68 in x 51 in  
66 cm x 173 cm x 130 cm

Usage class SA:  
For professional high-accuracy use.

The Concept2 StrengthErg is designed and produced to Usage Class rating "S" for professional, institutional and/or commercial use, and Accuracy Class "A" for High Accuracy Training Data, as defined per ISO 20957-1 Safety Standards.

## STRENGTHERG TECHNIQUE & ADJUSTMENTS

### SEATED ROW

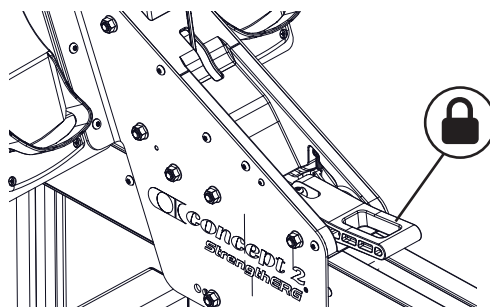
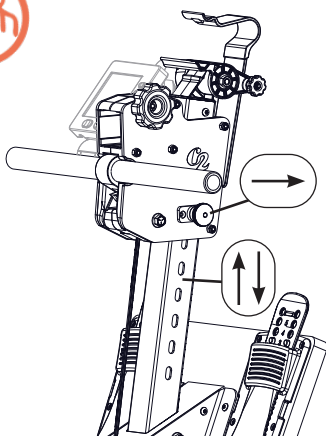

**Note:** Perform the seated row by planting your feet firmly on the foot plate to brace yourself in the seat.

Engaging the clamp helps stabilize the carriage and isolates upper body movement.

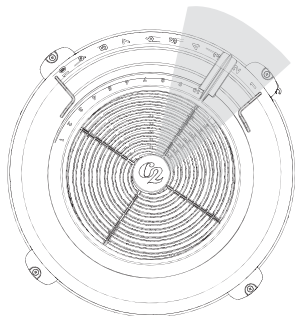

Set damper at approximately  
1-4

**concept2.com/damper**

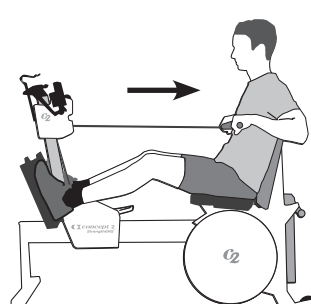
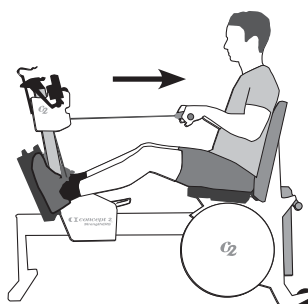
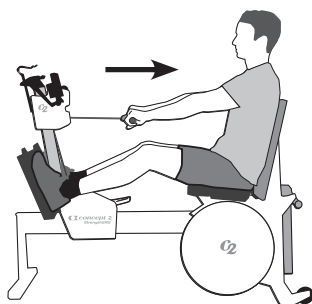

## LEG PRESS

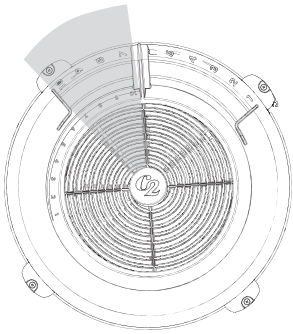

Set damper at approximately  
7-10  
[concept2.com/damper](http://concept2.com/damper)

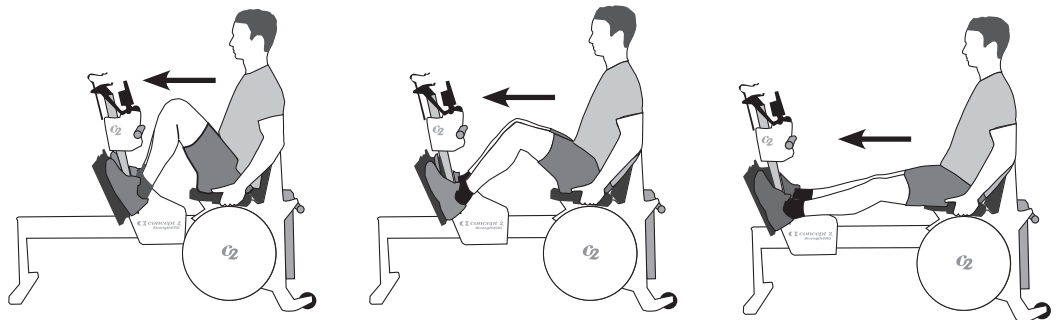

## CHEST PRESS

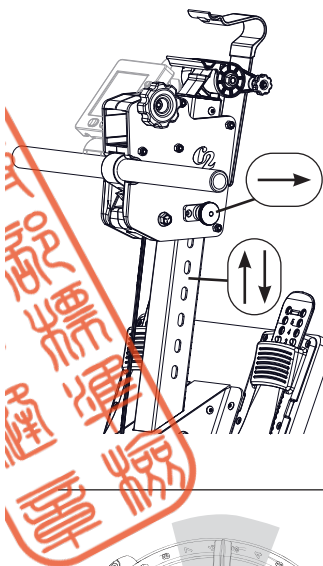

Set damper at approximately  
4-7  
[concept2.com/damper](http://concept2.com/damper)

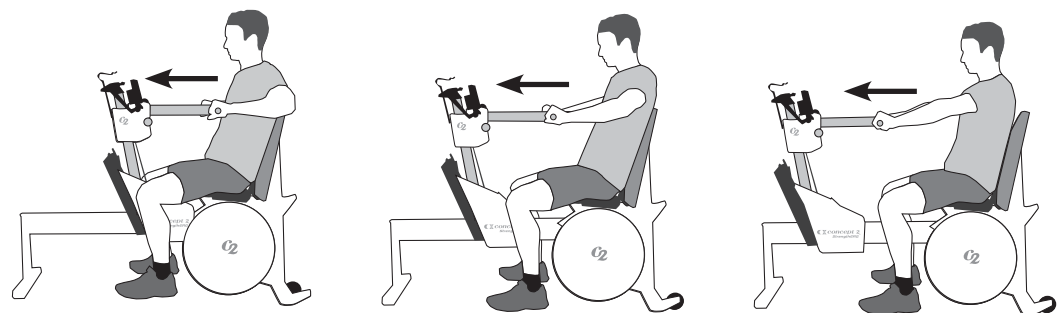
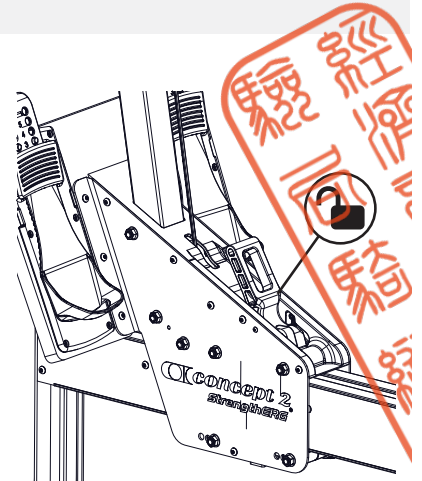
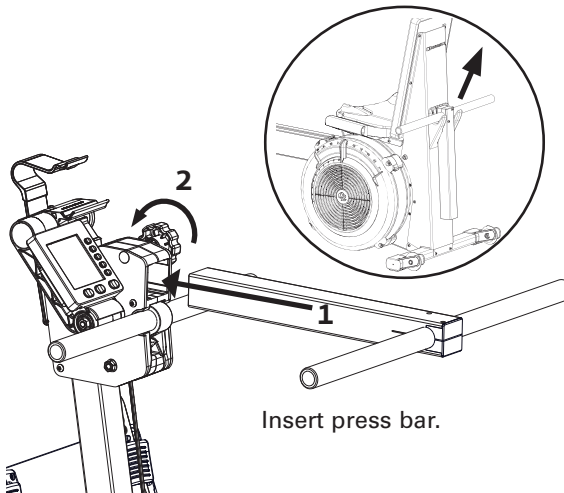

**STRENGTHERG TECHNIQUE**  
[c2vt.com/strength-technique](http://c2vt.com/strength-technique)



## BEFORE YOUR FIRST WORKOUT

- Consult your physician. Be sure that it is not dangerous for you to undertake a strenuous exercise program.
- Carefully review the StrengthErg technique. Improper technique can lead to injury.
- Gradually increase StrengthErg "work" time and intensity. If you increase the volume and intensity too quickly, fail to warm up properly, or use poor technique, you will increase the risk of injury.

## GETTING STARTED

### CONNECTING WITH THE STRENGTHERG ELECTRONICS & MEASUREMENT SYSTEM

The StrengthErg is equipped with "ErgLink" under the seat which automatically calibrates and produces your results which can be displayed and recorded on an optional PM5 monitor or using the free ErgData app.

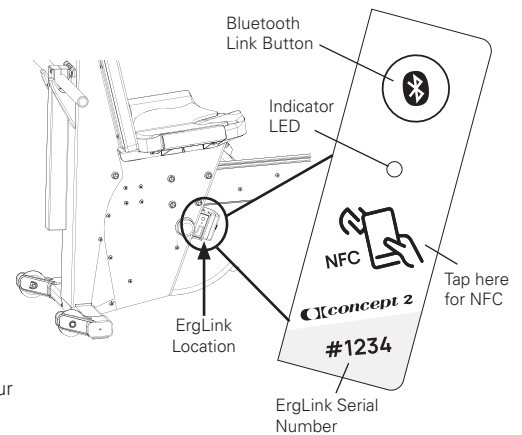

### HOW TO USE ERGDATA WITH THE STRENGTHERG WITHOUT A PM5



1

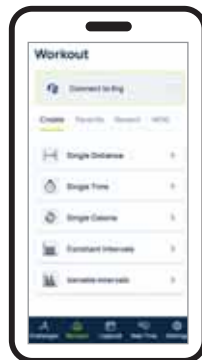

2

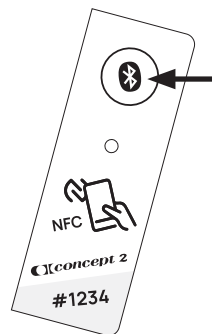

3



4

## PERFORMANCE MONITOR INFORMATION (PM5)

### HOW TO CONNECT TO ERGLINK WITH A PM5

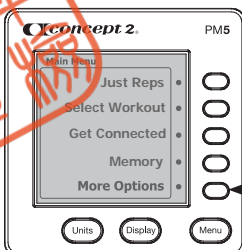

1

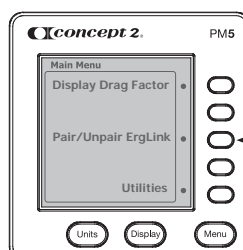

2

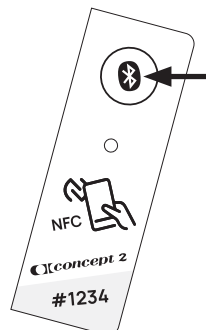

3

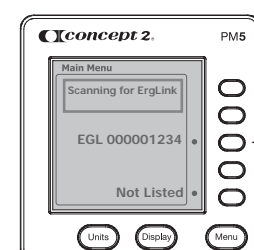

4



Use 1.5 volt alkaline D Cell (LR20) batteries.

**WARNING:** The PM5 should not be used or maintained by persons with reduced physical, sensory, or cognitive capabilities without instruction and/or supervision by a responsible individual. This includes children under eight (8) years old, who should be supervised to ensure they do not play with the PM5.

The ErgLink and PM5 are electronic devices powered by two (2) replaceable D-cell alkaline batteries and uses Bluetooth (2.4Ghz) wireless connection. Different types of batteries, or a mixture of new and used batteries, should not be used. Do not use lithium or 3.6 volt batteries, as there is risk of fire or explosion. Remove batteries when not in use for a period of four months or more. New D-cell alkaline batteries must be installed with the correct polarity. Spent batteries must be removed from the PM5 and disposed of safely.

### Using a Heart Rate Monitor:

The PM5 will receive and display heart rate data directly from a Bluetooth HR chest belt. See **Get Connected** for set up or use ErgData.

**WARNING!** Heart rate monitoring systems may be inaccurate. Over-exercising may result in serious injury or death. If you feel faint, stop exercising immediately.

### Cleaning the PM5 and ErgLink

Use a cloth lightly dampened with water only. Do not spray with a cleaner or store outdoors.

**Troubleshooting**  
concept2.com/pm5

# RECOMMENDED MAINTENANCE SCHEDULE

## AFTER FIRST 5 HOURS OF USE

- Check specified fasteners for tightness (1).

## DAILY USE

- Clean seat, press and pull bars, monorail, and flywheel cover with a cloth and all-purpose cleaner after use.
- Do not use bleach or coarse abrasives.

## ON A REGULAR BASIS

- Check fit of slider. Slider should move up and down smoothly on the mast, but without looseness. Adjust fasteners as needed.
- Check fit of carriage. Carriage should move smoothly on the rail, but without looseness. Adjust fasteners as needed.
- Inspect drive cord and bungee cord for wear. Some fuzzing is acceptable. Replace cord(s) with excessive wear (2).
- Verify the clamp securely holds the carriage in place when engaged (3). Adjust fasteners as needed.

## YEARLY

- Check specified fasteners for tightness (1).
- Check for dust inside flywheel with a flashlight. Vacuum if needed.

## NEED ADDITIONAL SUPPORT?

For complete maintenance information and instructions:

[concept2.com/support/strengtherg](https://concept2.com/support/strengtherg)



## IMPORTANT USE AND SAFETY NOTES

- The machine should be used on a stable, level surface.
- To move the StrengthErg, engage the carriage clamp, grasp the front foot and lift until the caster wheels start to roll (4).
- The clamp is not a positive stop and can be overpowered (3).
- The StrengthErg is intended for indoor use.
- Use of this machine with a worn or weakened part may result in injury to the user.
- When in doubt about the condition of any part, Concept2 strongly advises that you replace the part immediately with genuine Concept2 replacement parts. Use of other replacement parts may result in injury or poor performance of the machine.
- **WARNING:** Keep unsupervised children away from the equipment. Keep pets and fingers away from the carriage, which can cause injury.
- Do not stand the StrengthErg up on end as the StrengthErg may tip over (5).
- Perform proper maintenance as described in the Maintenance section.

**WARNING!** Replace defective components immediately to ensure safety and performance, or keep the machine out of use until it is repaired. Incorrect or over-exercising may result in serious injury or death. If you feel faint, stop exercising immediately.

## WARRANTY

Concept2 StrengthErgs are backed by a limited 2 year and 5 year warranty. For complete warranty information in the US and Canada, visit [concept2.com/warranty](https://concept2.com/warranty).

For complete warranty information outside the US and Canada, contact the authorized Concept2 Preferred Reseller in your territory. A list of authorized Concept2 Preferred Resellers can be found at [concept2.com/international](https://concept2.com/international). If you do not find a Preferred Reseller in your territory email [c2global@concept2.com](mailto:c2global@concept2.com).

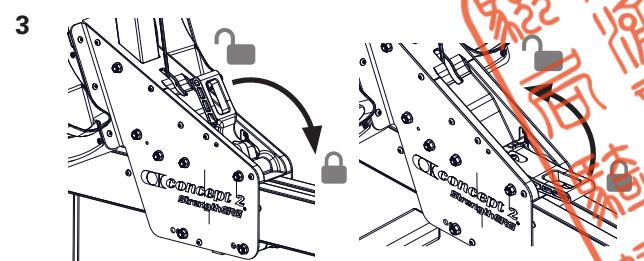
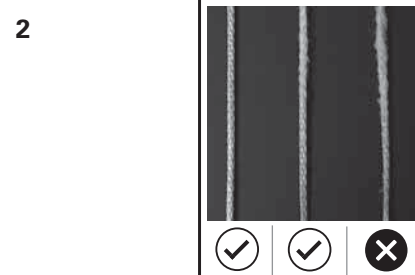
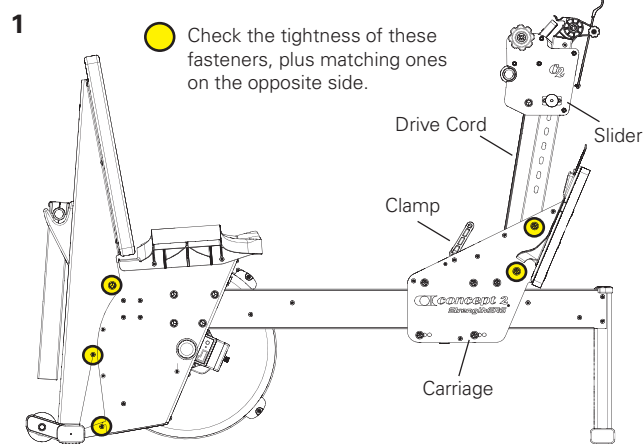

**Note:** Perform the seated row by planting your feet firmly on the foot plate to brace yourself in the seat.

Engaging the clamp helps stabilize the carriage and isolates upper body movement.

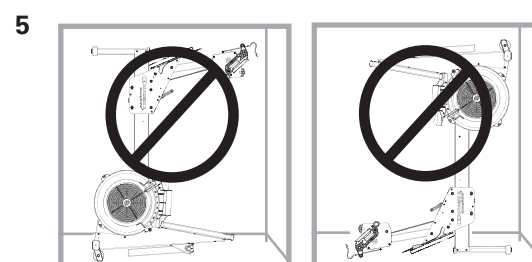
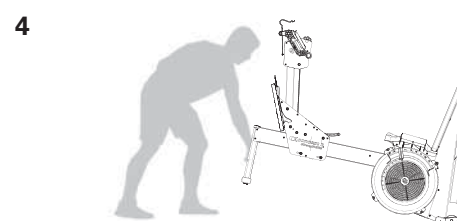



## COMPLIANCE INFORMATION:

PM5 FCC ID: J2MPM5N ERGLINK FCC ID: J2MEL1

WARNING: Changes or modifications to this unit not expressly approved by the party responsible for compliance could void the user's authority to operate the equipment.

NOTE: This equipment has been tested and found to comply with the limits for a Class B digital device, pursuant to Part 15 of the FCC Rules. These limits are designed to provide reasonable protection against harmful interference in a residential installation. This equipment generates, uses, and can radiate radio frequency energy and, if not installed and used in accordance with the instructions, may cause harmful interference to radio communications. However, there is no guarantee that interference will not occur in a particular installation. If this equipment does cause harmful interference to radio or television reception, which can be determined by turning the equipment off and on, the user is encouraged to try to correct the interference by one or more of the following measures:

- Reorient or relocate the receiving antenna.
- Increase the separation between the equipment and receiver.
- Consult the dealer or an experienced radio/TV technician for help.

This device complies with Part 15 of the FCC. Operation is subject to the following two conditions: (1) This device may not cause harmful interference, and (2) this device must accept any interference received, including interference that may cause undesired operation.

PM5 IC: 6620A-PM5N HVIN:PM5N ERGLINK IC: 6620A-EL1 HVIN:EL1  
Industry Canada (IC) Compliance Statement

This device complies with Industry Canada licence-exempt RSS standard(s). Operation is subject to the following two conditions:

(1) this device may not cause interference, and (2) this device must accept any interference, including interference that may cause undesired operation of the device.

Industrie Canada (IC) Déclaration de conformité

Le présent appareil est conforme aux CNR d'Industrie Canada applicables aux appareils radio exempts de licence. L'exploitation est autorisée aux deux conditions suivantes : (1) l'appareil ne doit pas produire de brouillage, et (2) l'utilisateur de l'appareil doit accepter tout brouillage radioélectrique subi, même si le brouillage est susceptible d'en compromettre le fonctionnement.

The Concept2 PM5 is compliant with all applicable European Union CE Marking Directives, including:

- Directive 2014/53/EU of the European Parliament and of the Council of 16 April 2014 (RED Directive) on the harmonization of the laws of the Member States relating to the making available on the market of radio equipment.
- Directive (EU) 2015/863 of 31 March 2015, which amends Directive 2011/65/EU on the Restriction of the Use of Certain Hazardous Substances in Electrical and Electronic Equipment.



The PM5 should not be disposed of with other household waste. To prevent possible harm to the environment or human health from uncontrolled waste disposal, recycle the PM5 responsibly. To return your used device for environmentally safe recycling, please use the return and collection systems or contact the retailer where the product was purchased. Directive 2012/19/EU.

Additional regulatory and compliance information may be found in the PM5 by pushing **More Options > Utilities > More Utilities > Regulatory**.

Do not connect with Ethernet or networking equipment.

取得實驗證明之低功率射頻器材，非經核准，公司、商號或使用者均不得擅自變更頻率、加大功率或變更原設計之特性及功能。

低功率射頻器材之使用不得影響飛航安全及干擾合法通信；經發現有干擾現象時，應立即停用，並改善至無干擾時方得繼續使用。

前述合法通信，指依電信管理法規定作業之無線電通信。

低功率射頻器材須忍受合法通信或工業、科學及醫療用電波輻射性電機設備之干擾。

# **concept 2**<sup>®</sup>



Designed by:  
Concept2, Inc.  
105 Industrial Park Drive  
Morrisville, Vermont 05661 USA  
[concept2.com/contact](http://concept2.com/contact)

EU Sales & Service Headquarters:  
Concept2 Deutschland GmbH  
Neumann-Reichardt-Straße 27-33  
22041 Hamburg, Germany

0525\_temp

## Introduction

The Concept2 ErgLink is an electronic device that mounts next to the flywheel on Concept2 ergometers. It integrates the capabilities of Concept2's performance monitor and generator into a single package. The ErgLink collects and processes data about the workout and transmits this data via a Bluetooth low energy link to a remote display and another device such as a smartphone or tablet.

## Device Information

Power	
Primary Power Source	DC 3V by 2xLR20 batteries
Secondary Power Source	DC 4V flywheel generator while workout is in progress
Auxiliary Power Source	DC 5V when connected to a USB host.  Note: USB cable is not provided by Concept2 and is not required for normal device operation. USB may be used for firmware updates, logbook maintenance and diagnostics. However, BLE is the primary interface for all of those functions.
Power Consumption	30mW max
Bluetooth 2.4GHz	
Bluetooth Version	5.3 Low Energy
Max Transmit Power	+3dBm
Data Rate	1Mbps
Modulation Type	GFSK
Number of Channels	40
Channel Spacing	2MHz

Antenna Type	PCB
Antenna Gain	Approx 3.3 dBi. Antenna design is based on the <a href="#">Tlinverted F antenna application report, SWRU120C</a> .

User Interface	
Indicator(s)	Bi-color LED
Button(s)	Singlemomentary pushbutton switch
External Interface	
USB	USB2.0 full speed device, 12Mbs, type C connector
Race Adapter (optional)	RS485, RJ45jack

